

| Rev: | Date | By | Chk | Description |
|------|------|----|-----|-------------|
| -    | -    | -  | -   | -           |

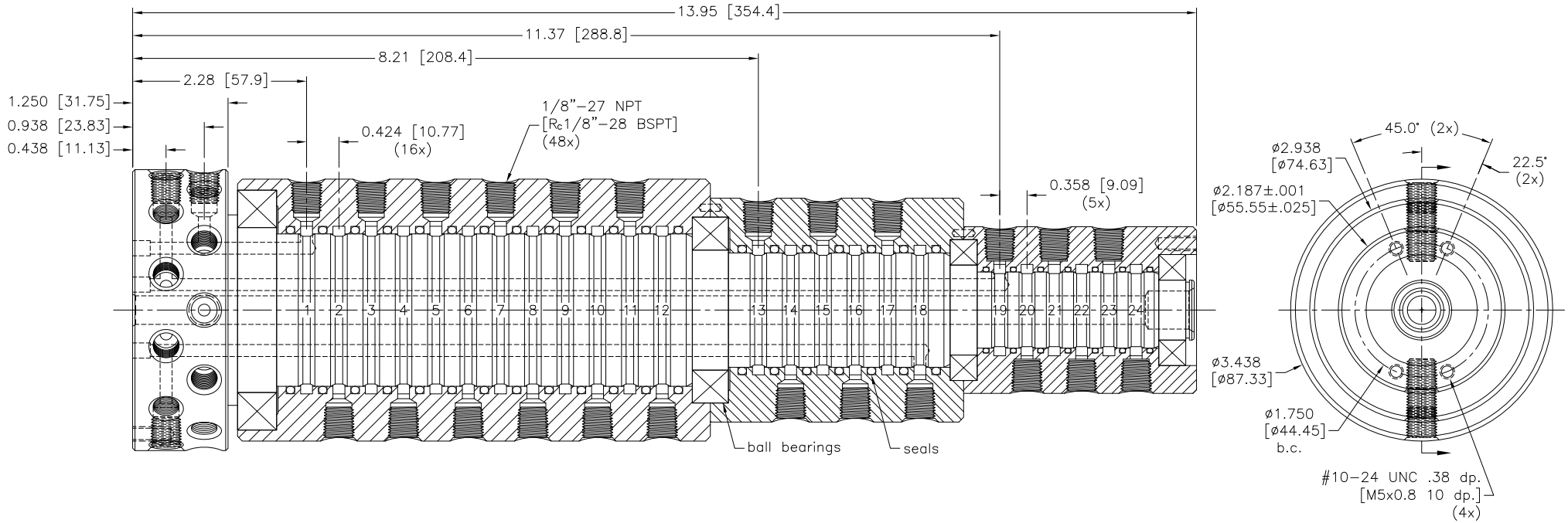

**Notes:**

1. Union will be static air tested.
2. Media must be filtered, clean and free of abrasive content or reduced union life will result.
3. Alternate metric units and threads apply to the LTM configurations. See page 2 for details.

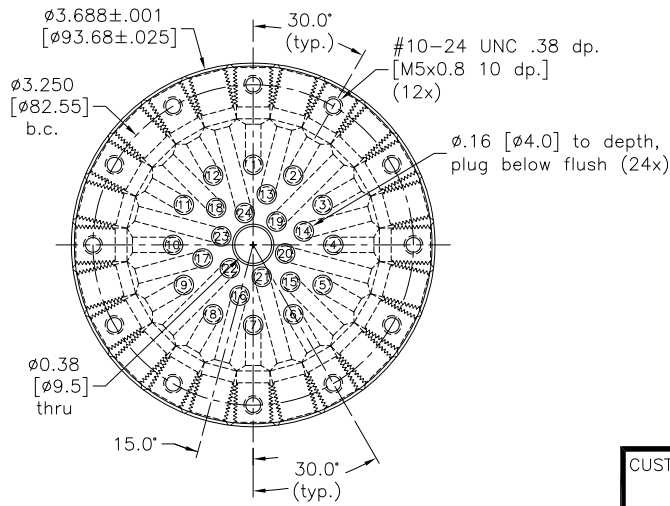

|         |     |         |
|---------|-----|---------|
| Drawn   | PJE | 9/20/11 |
| Checked | JLA | 9/22/11 |
| Checked | TCB | 9/23/11 |

|                           |        |
|---------------------------|--------|
| TOLERANCE EXCEPT AS NOTED |        |
| X.X                       | ±.125  |
| X.XX                      | ±.015  |
| X.XXX                     | ±.005  |
| ANGLES                    | ± 0.5° |

**DSTI**  
**DYNAMIC SEALING TECHNOLOGIES, INC**  
 13829 JAY ST NW ~ ANDOVER, MN 55304  
 866-700-DSTI (3784)

CUSTOMER APPROVAL/DATE:

SHAFT MTL/PLTING:  
 6061 ALUM  
 E-NICKEL

CUSTOMER:  
 STOCK

THIS DOCUMENT CONTAINS INFORMATION WHICH IS PROPRIETARY TO DYNAMIC SEALING TECHNOLOGIES, INC. (DSTI) NO REPRODUCTION OR PUBLICATION OF THIS DOCUMENT OR IT'S CONTENTS, IN WHOLE OR PART, SHALL BE MADE WITHOUT THE WRITTEN CONSENT FROM DSTI.

HOUSING MTL/PLTING:  
 6061 ALUM  
 BLUE ANNO DIZE

P/N:  
 LT(M)-21241

REV:  
 A

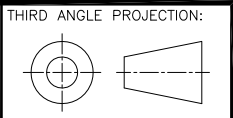

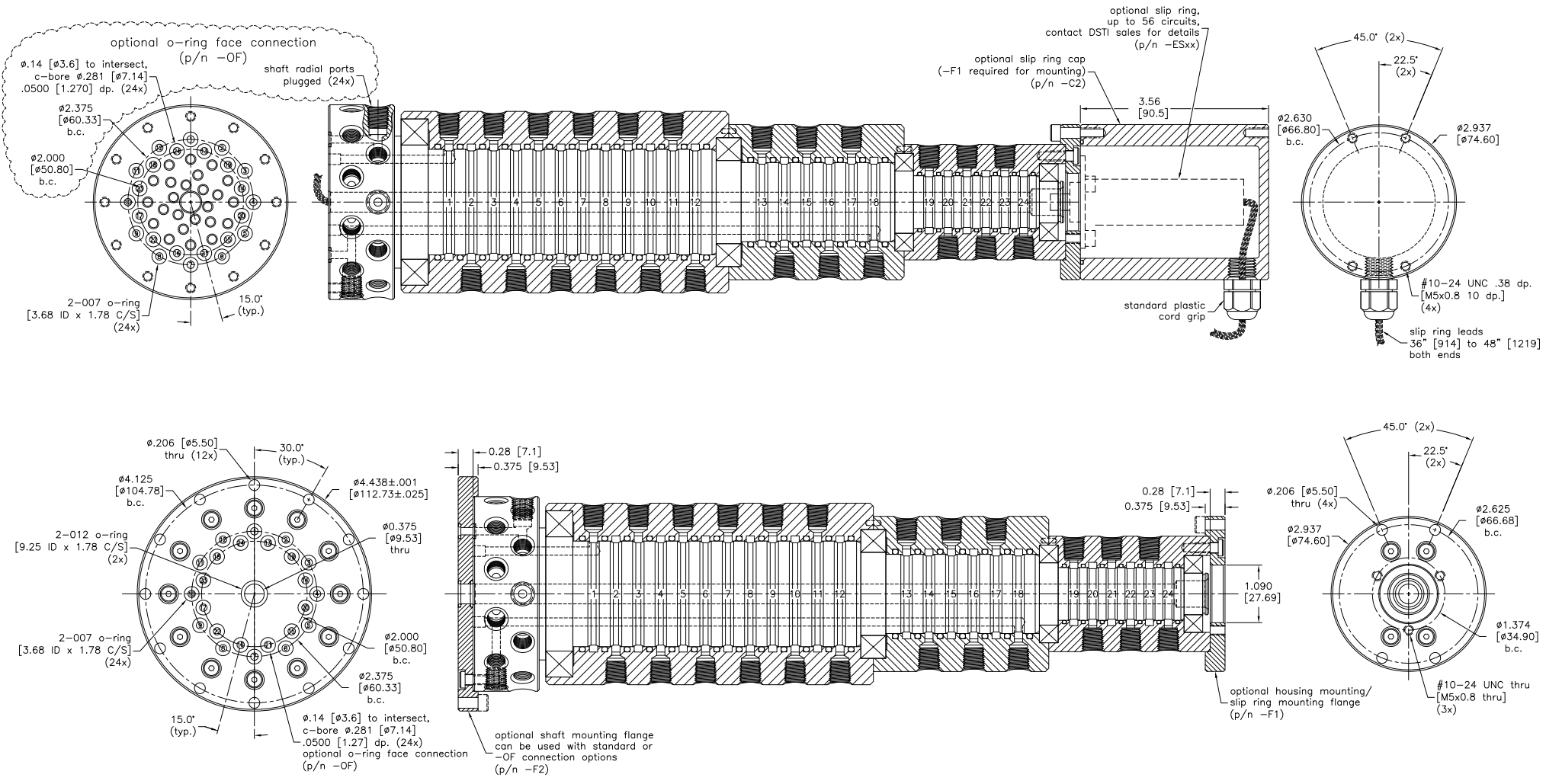

Notes:

1. Metric connections and threads available by using LTM in place of LT in the series designation prefix.

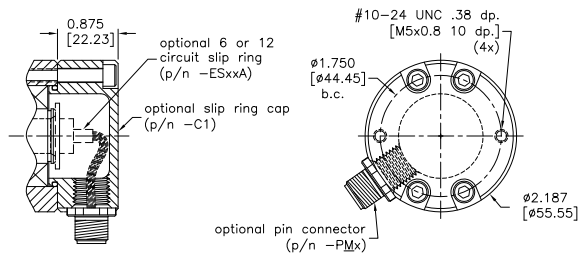

|         |     |         |
|---------|-----|---------|
| Drawn   | PJE | 9/20/11 |
| Checked | JLA | 9/22/11 |
| Checked | TCB | 9/23/11 |

| TOLERANCE EXCEPT AS NOTED |        |
|---------------------------|--------|
| X.X                       | ±.125  |
| X.XX                      | ±.015  |
| X.XXX                     | ±.005  |
| ANGLES                    | ± 0.5° |

**DSTI**  
 DYNAMIC SEALING TECHNOLOGIES, INC  
 13829 JAY ST NW ~ ANDOVER, MN 55304  
 866-700-DSTI (3784)

CUSTOMER APPROVAL/DATE:

THIS DOCUMENT CONTAINS INFORMATION WHICH IS PROPRIETARY TO DYNAMIC SEALING TECHNOLOGIES, INC. (DSTI) NO REPRODUCTION OR PUBLICATION OF THIS DOCUMENT OR IT'S CONTENTS, IN WHOLE OR PART, SHALL BE MADE WITHOUT THE WRITTEN CONSENT FROM DSTI.

FLANGES MTL/PLTING:  
 6061 ALUM  
 BLUE ANNOIDIZE

CAPS MTL/PLTING:  
 6061 ALUM  
 BLUE ANNOIDIZE

CUSTOMER:  
 STOCK

P/N:  
 LT(M)-21241-SEE NOTES

REV:  
 A