

All rights strictly reserved.
Reproduction or issue to third parties in any form whatever is not permitted without written authority from the property

Tutti i diritti sono strettamente riservati. La riproduzione o la comunicazione a terzi è vietata, in qualunque forma senza autorizzazione scritta della proprietà

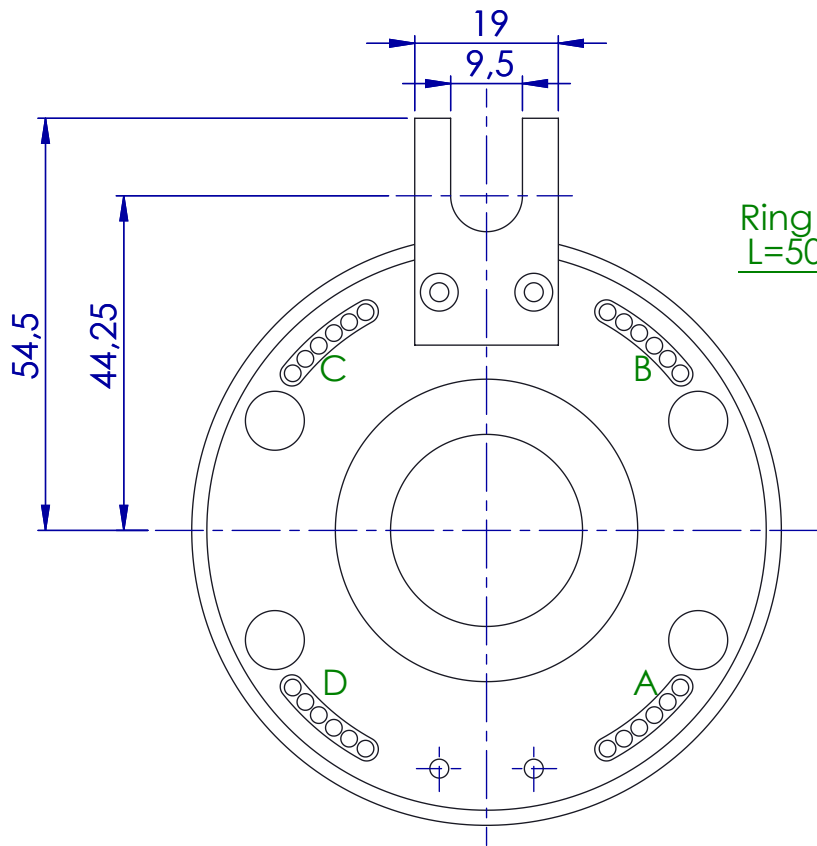

Ring Lead Exit
L=500±30mm

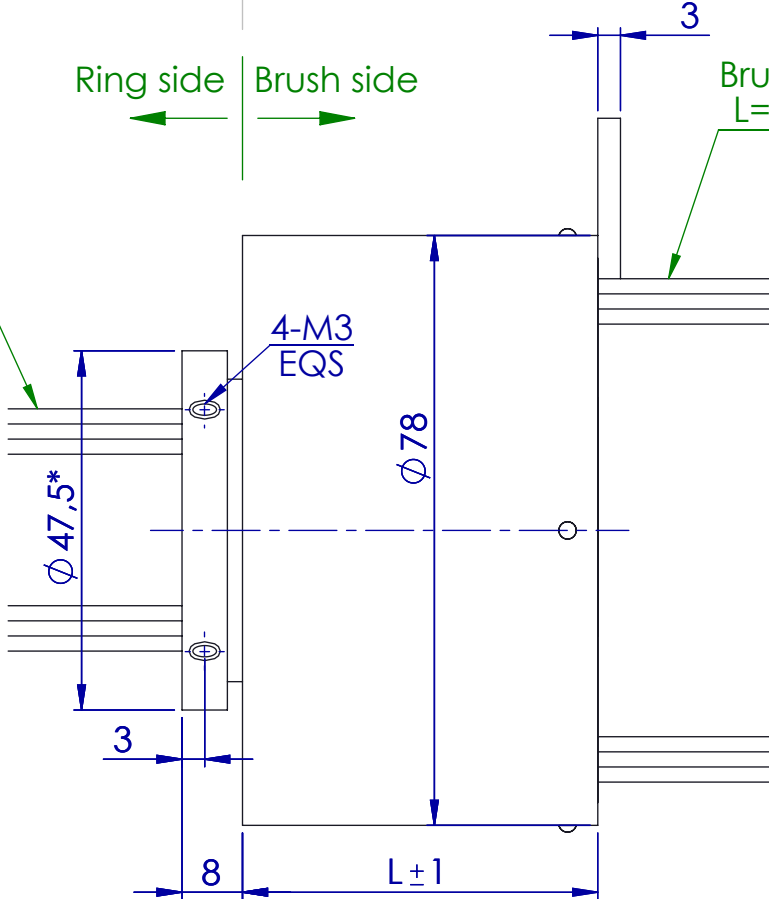

Brush Lead Exit
L=500±30mm

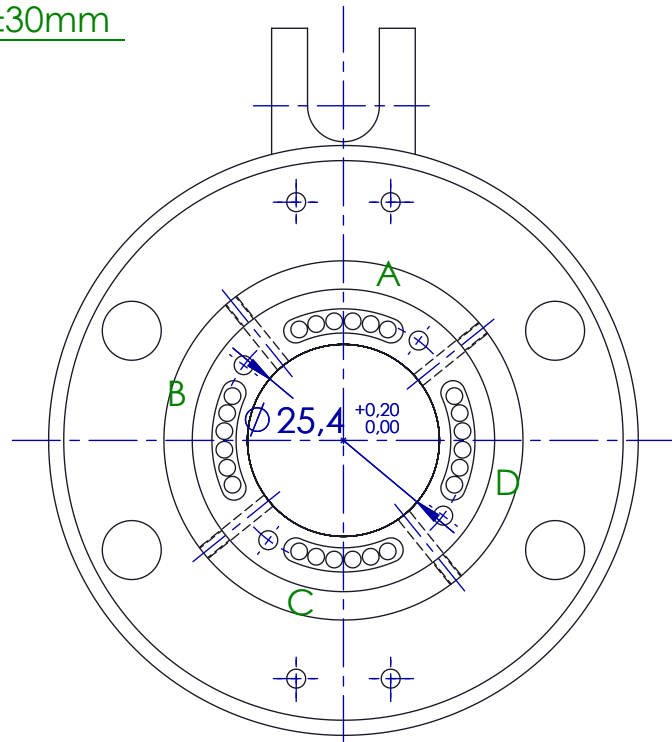

	Total	Power	Signals	L	Weight(kg)	
		15A	2A		IP51	IP65
SVTS C 04-x-A-06/00	6	6	-	47	0,5	0,8
SVTS C 04-x-A-00/12	12	-	12	47	0,5	0,8
SVTS C 04-x-A-12/00	12	12	-	71	0,8	1,1
SVTS C 04-x-A-06/12	18	6	12	71	0,8	1,1
SVTS C 04-x-A-00/24	24	-	24	71	0,8	1,1
SVTS C 04-x-A-18/00	18	18	-	95	0,9	1,4
SVTS C 04-x-A-12/12	24	12	12	95	0,9	1,4
SVTS C 04-x-A-06/24	30	6	24	95	0,9	1,4
SVTS C 04-x-A-00/36	36	-	36	95	0,9	1,4
SVTS C 04-x-A-24/00	24	24	-	119	1,2	1,7
SVTS C 04-x-A-18/12	30	18	12	119	1,2	1,7
SVTS C 04-x-A-12/24	36	12	24	119	1,2	1,7
SVTS C 04-x-A-06/36	42	6	36	119	1,2	1,7
SVTS C 04-x-A-00/48	48	-	48	119	1,2	1,7

*Note: IP65 option L=L+15mm and Ø39,5mm - Housing material aluminum alloy

Technical specification		
	Power rings	Signal rings
Leads size	AGW 14	AWG 26
Leads	Tinning PTFE	
Rated voltage	600Vac/600V dc	240Vac/240V dc
Rated current	15A	2A
Dielectric strength	min1500Vac@50Hz, 60s	min500Vac@50Hz, 60s
Insulation resistance	min1000M Ohm/500V dc	min500M Ohm/500V dc
Dynamic contact resistance	max 0,01	
Contact material	Precious metals	
Frame material	Engineering plastic*	
Temperature range	-20°C~+80°C (ET option -40°C~+80°C)	
Suggested speed	0-600 rpm	
Sealing	IP51*	

TRATTAMENTO TREATMENT:		4		20/01/2017	Aggiunto identificativo uscita fili						
		3		01/06/2016	Aggiornamento Part Number						
		2		02/11/2015	Aggiunta valori di massa						
		1		18/10/2012	Correzione caratteristiche elettriche e meccaniche						
		0		21/05/2012	Prima emissione						
MATERIALE MATERIAL:		REV. Nr	DATA/DATE	DESCRIZIONE/DESCRIPTION							
		REV N°									
PESO WEIGHT		Tolleranze/Tolerances UNI EN 22768-1		TITLE - TITOLO SVTS C 04			DRAWING Nr. - DISEGNO N° 000-072				
		FINE									
		MEDIA		x							
		GROSSOLANA									
		MOLTO GROSSOLANA									
				DATE DATA		21/05/2012	SH. FG.		1	CODICE SERVOTECNICA	
				CHECK CONTR.		AG	DRAW. DIS.		AG		
		FORM A3		PROPERTY PROPRIETÀ SERVOTECNICA S.P.A. - VIA MAJORANA,4 - NOVA MILANESE(MB) - www.servotecnica.com							