

ACCESSORIES	
PART NUMBER	DESCRIPTION
8800065	LAY70X3 Blank Pole Shoe
8800078	LAY70x3 Standard Pole Shoe
280032	SMC CDRB1BW100-180S

Max Breakaway	2875 lbs / 1304 kg
Safe Working Load	719 lbs / 326 kg
Optimum Material Thickness	1/2" / 12.7 mm

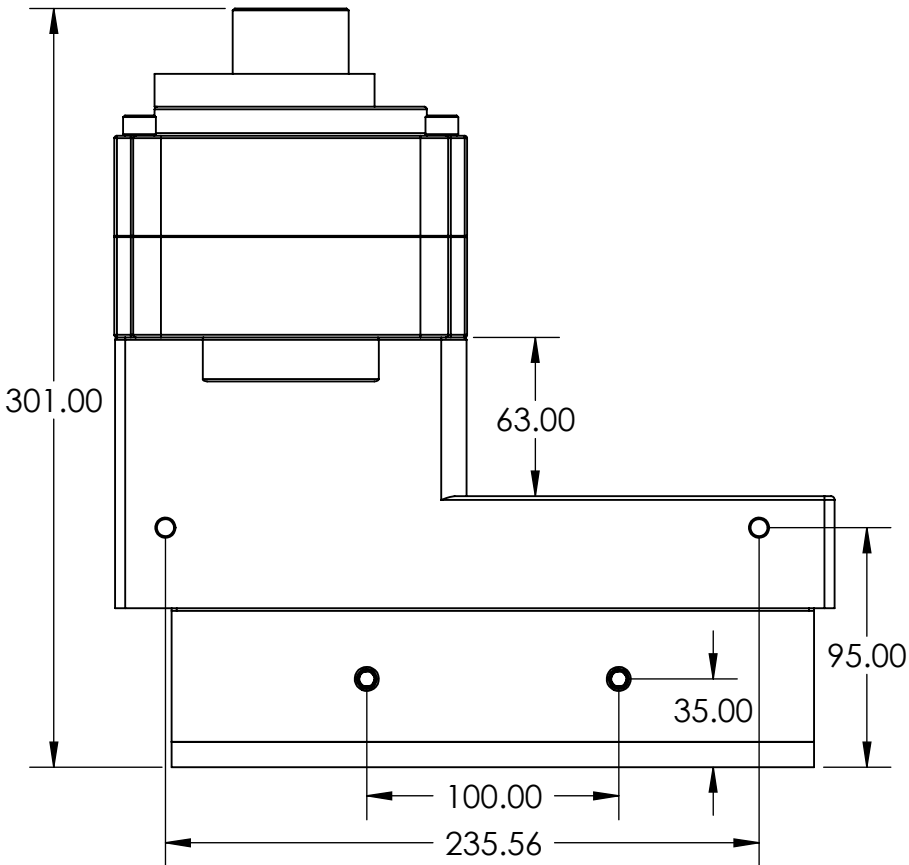
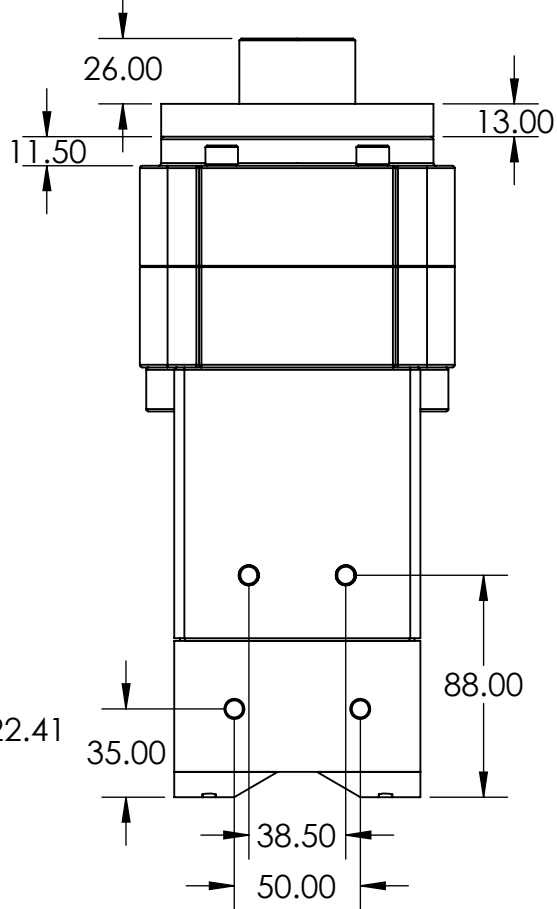
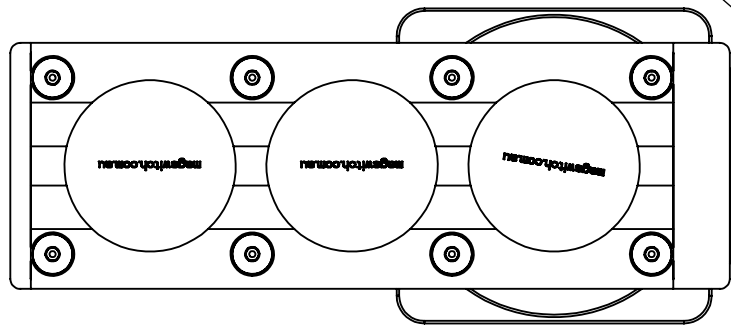
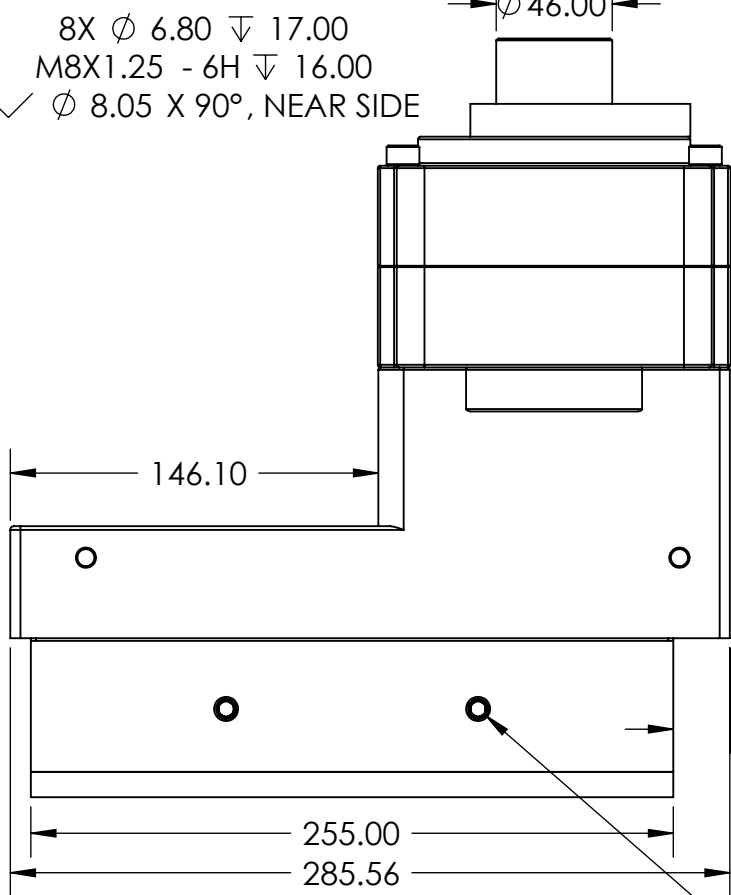
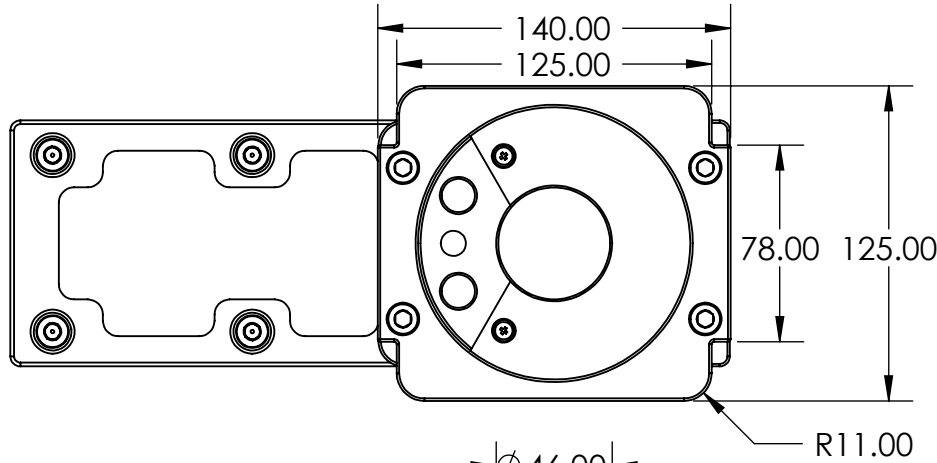
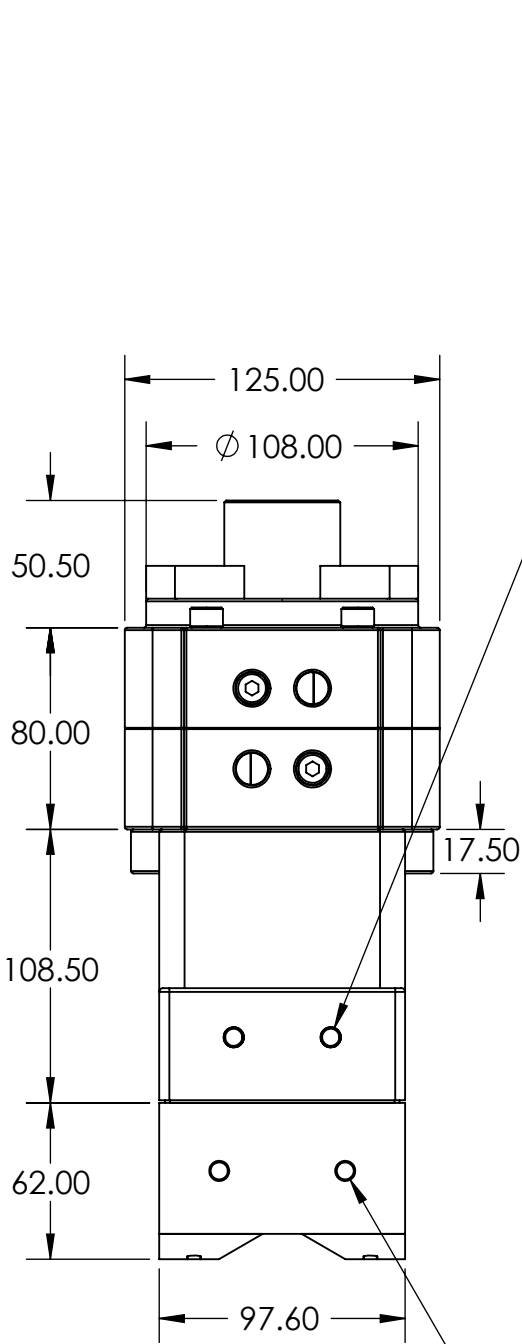

THIS DOCUMENT, AND THE INFORMATION IT CONTAINS, INCLUDING THE PRINCIPLES OF DESIGN, IS THE EXCLUSIVE PROPERTY OF MAGSWITCH TECHNOLOGY WORLDWIDE AND IS CONFIDENTIAL. ACCORDINGLY, THIS INFORMATION IS SUBMITTED TO YOU WITH THE AGREEMENT THAT IT IS NOT TO BE REPRODUCED, COPIED, OR LOANED IN PART OR IN WHOLE, NOR IS THE INFORMATION TO BE RELAYED TO ANY OTHER INDIVIDUAL OR COMPANY EXCEPT AS MTW FIRST AUTHORIZES IN WRITING. ACCEPTANCE OF THIS DOCUMENT CONSTITUTES AGREEMENT TO THESE RESTRICTIONS.

INTERPRET DRAWING PER:
ISO 2768-M

DIMENSIONS
ARE IN
MILLIMETERS

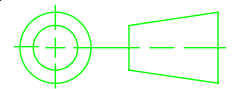

THIRD ANGLE PROJECTION

DO NOT SCALE

DRAWN

Y. Yan

DESIGN

STD. CHECK

F/F CHECK

APPROVED

DATE

9/6/2012

DATE

DATE

DATE

DATE



8774 YATES DRIVE, SUITE 140
WESTMINSTER, COLORADO 80031
303-468-0662 / FAX 303-951-9918

TITLE:

PLAY70x3 MDC HT

SIZE

B

CAGE CODE

DWG. NO.

8140544

REV

1

SCALE 1:3

WEIGHT: 16364.56 g

SHEET 1 OF 1